

GLOBAL AIR SUPPLIES UK

EC 5 CONTROLLER

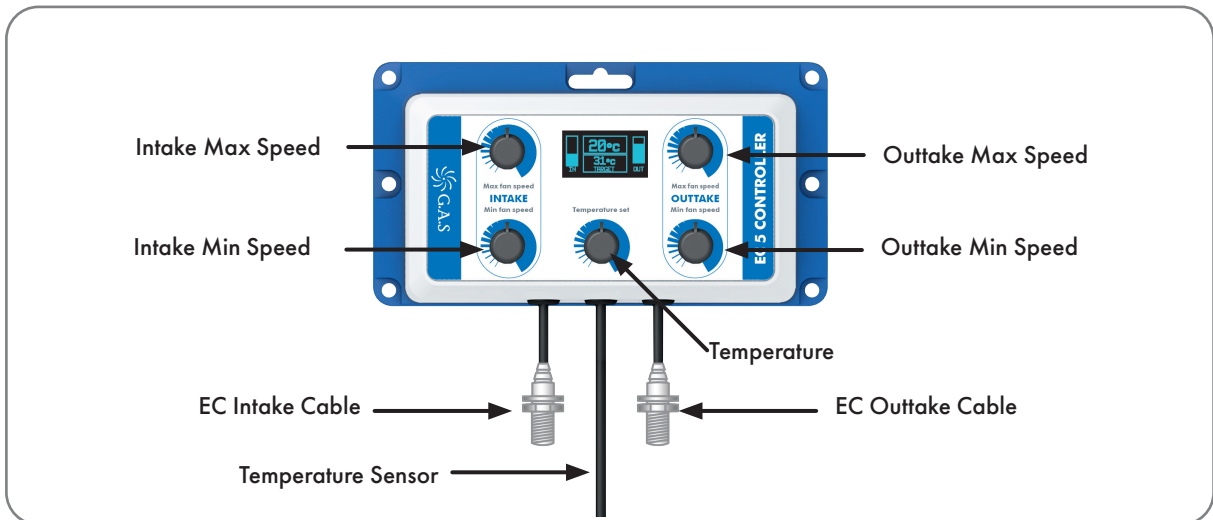

STEP 1

CONNECTING TO YOUR FANS USING ACTIVE CABLES

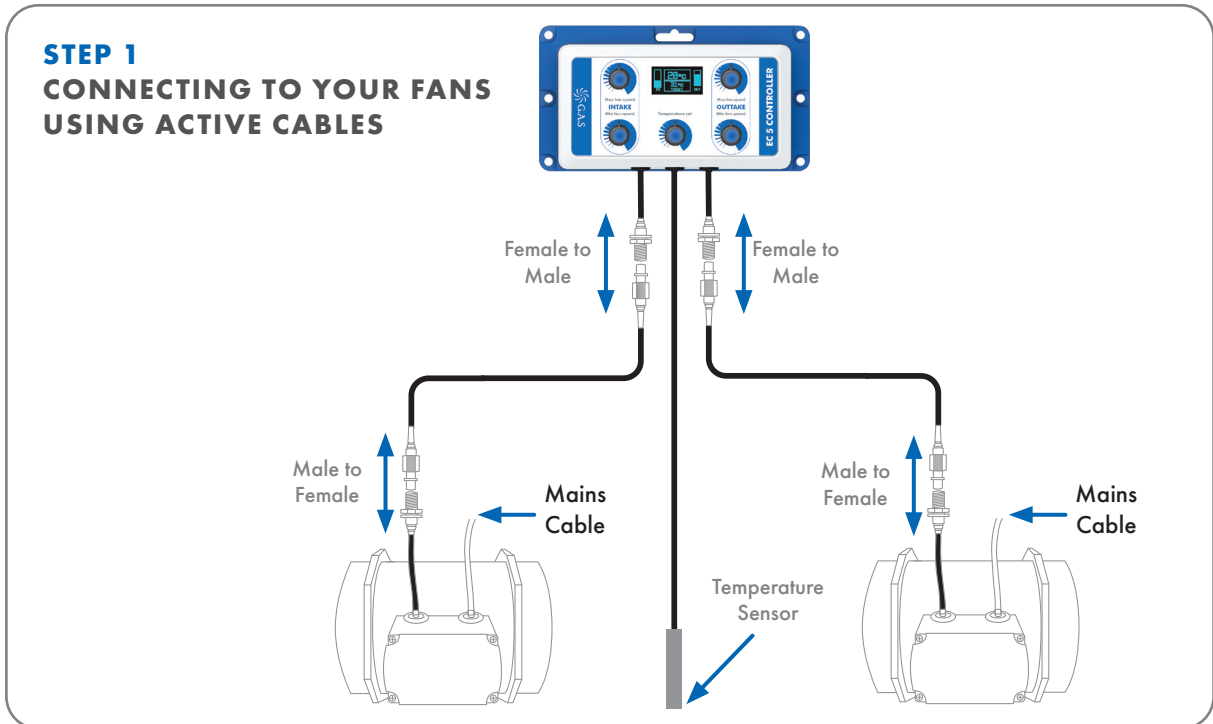

STEP 2

SETTING TEMPERATURE

You can set the temperature between 11 °C & 40 °C with the centre dial.

Turn the dial clockwise to increase the set temperature. Turn it counter-clockwise to decrease the set temperature.

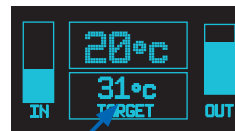

Set temperature

Turn the dial counter clockwise all the way to show the logged lowest and highest temperature values.

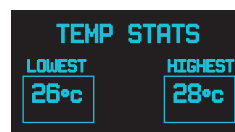

STEP 3 SETTING UP FANS

You can set the minimum and maximum speed of your fans.

Bear in mind, when changing these setting that you will likely want your outtake fan to run faster than your intake fan to maintain negative pressure.

Intake and outtake fans run independently on this controller. Balance is achieved by the fan speed on the outtake being higher than the intake fan.

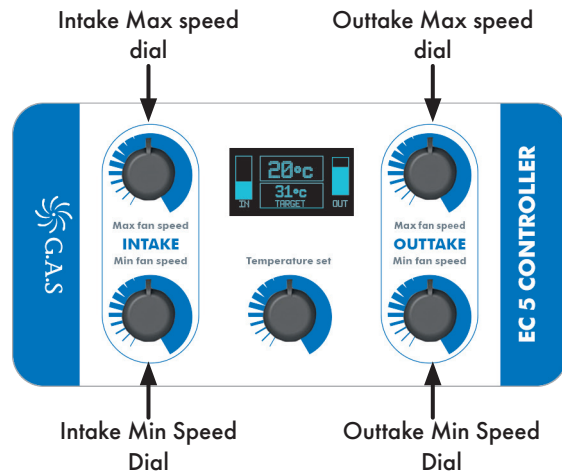

EXAMPLE INTAKE

The intake maximum speed is set to 90%

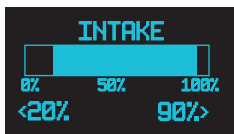

The minimum speed is 20%

EXAMPLE OUTTAKE

Here the outtake fan is set to maximum speed 100%

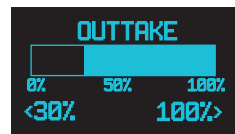

The minimum speed is 30%

In this example, minimum speed of the outtake will be 10% faster, and at maximum speed the outtake will be 10% faster.

THE SCREEN MAIN SCREEN

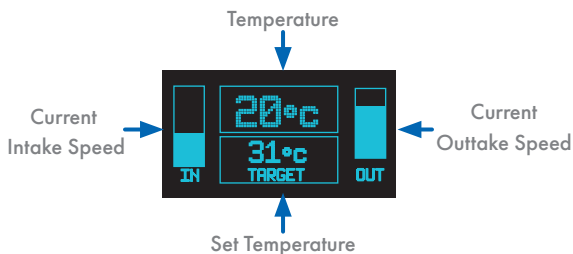

IN THE BOX

- 1 x EC 5 Controller
- 1 x Active Male/Male Cable

TEMPERATURE SENSOR

The temperature sensor will work best in the centre of your room. You should ensure there is ventilation of the air to prevent hot spots, such as a DiffuseAir or oscillating fans.

Shading the probe from direct light will give best results.

